

# MURRAY COUNTY.

Section 36

Township 106

Range 39

10798 McGill-Warner Co., Blank Book Manufacturers, St. Paul.

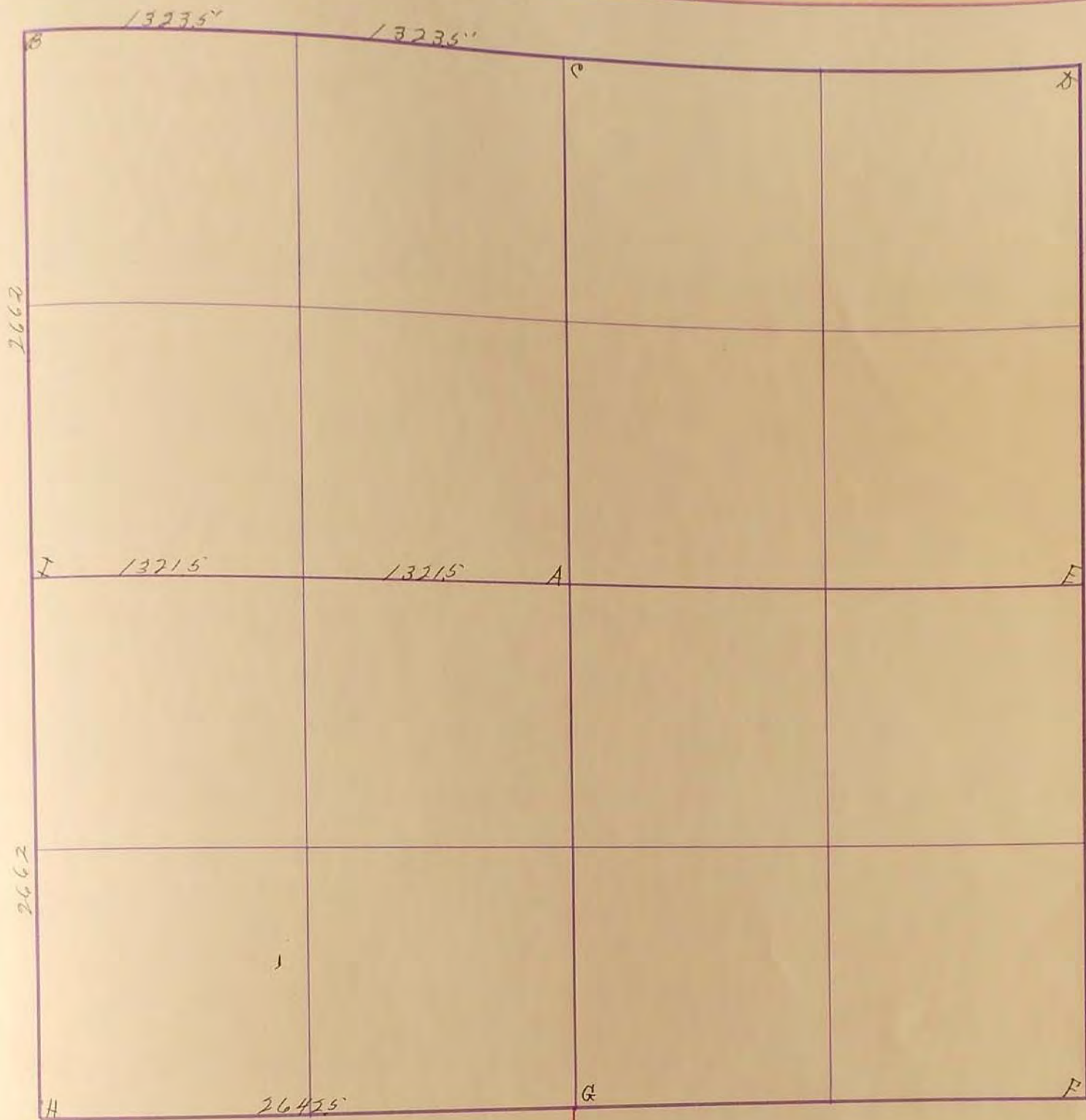

May 4-1903

Recorded by error on 105-39

- A Stone
- B. Stone & stake
- C.
- D.
- E. Cor. M. & Stake
- F
- G
- H. Stone in grade
- I

Fence post West 238'. Fence post East 353'

Cor. cor. at B, C, D, E, F, G, H, I established A-H-I

"H" Stone: R.P. Tack blazed 10" Cottonwood Tree S.E. 462': R.P. Tack in N.W. cor. fence post 332'

"I" Iron Pin R.P. N.40. in T.P.E. 492', N.40. in P.P. S.W. 97.7' - 1966

"B" Stone: R.P. Tack in cor. fence S.E. 453': R.P. Tack in cor. fence Post N.E. 462'

July 23, 1936

"B" CONCRETE STONE Edge of steel culvert in school yard 47.7: Tack in cor. post N.E. 46.9 (R.P. gone 1974)

"H" ~~Iron Stake Hub SW 502: Hub NW 500~~

"H" CONCRETE STONE R.P. Tack in cor. post N.W. 41.2 fence running West 23.5' N. of stone. R.P. Blazed Box Elder S.E. 71.6

"I" CONCRETE STONE: R.P. Tack in cor. fence post West 33.6' R.P. Tack in fence post S.W. 42.5'; Try R.P. dated 1966 (left column)

"C" R.P. Stone 3.7 ft. Below oil mat; See "G" Sec. 25-106-39.



SURVEY No. \_\_\_\_\_

Section 36

Town 106

Range 39

C

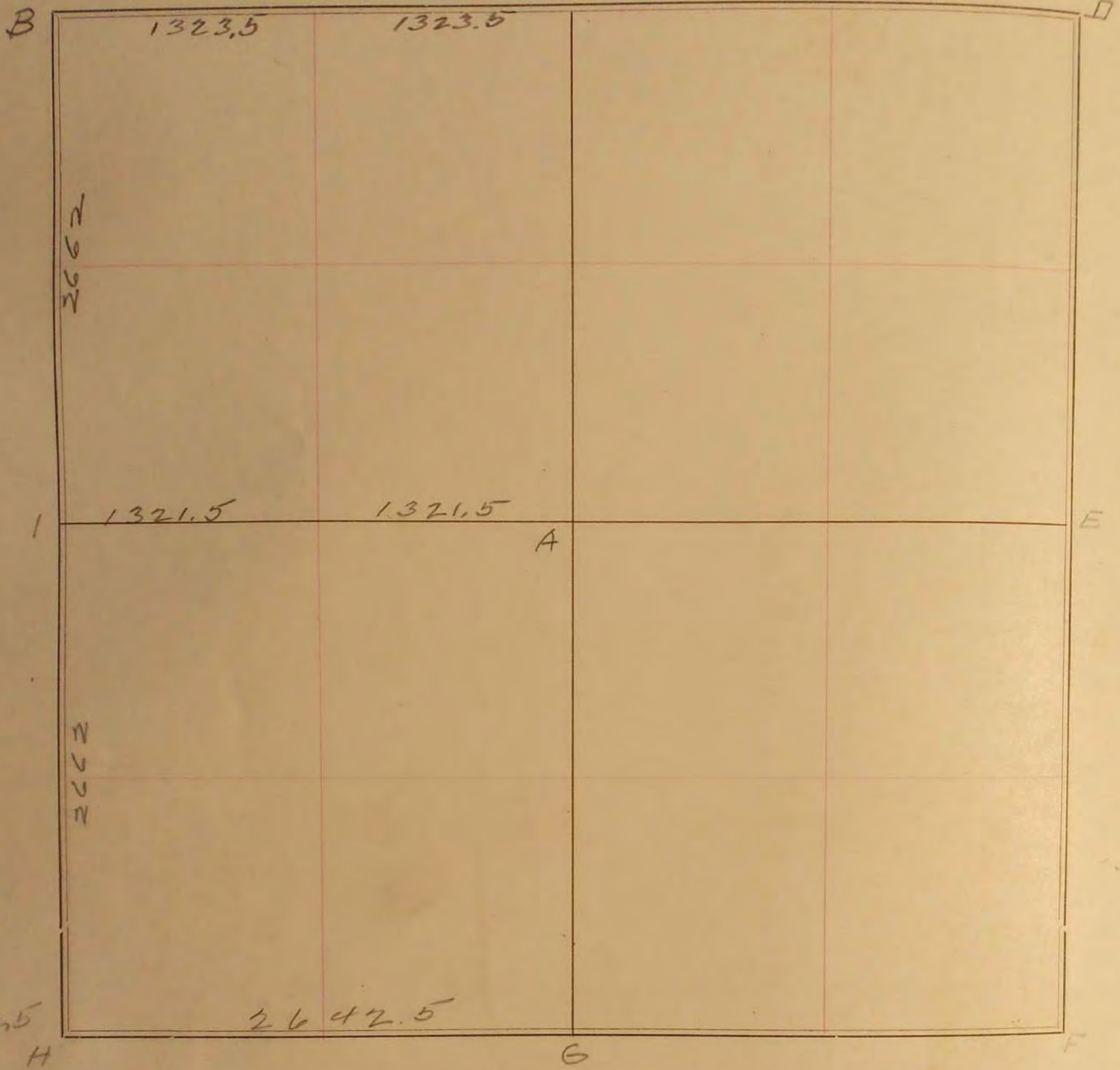

FIELD NOTES.

May 4, 1903  
 Recorded by error on 105-39

- A Stone
- B Stone and stake
- C
- D
- E Mon. W & Stake
- F " " "
- G " " "
- H Stone in grade
- I

Mon. Cor at B-C-D-E-F-G-  
 Established A-H-I-

2644  
 2690  
 5334